

# 8 Foot Monarque Park Bench

For Fastener Pack  
(FP-MB8B-CU-01)

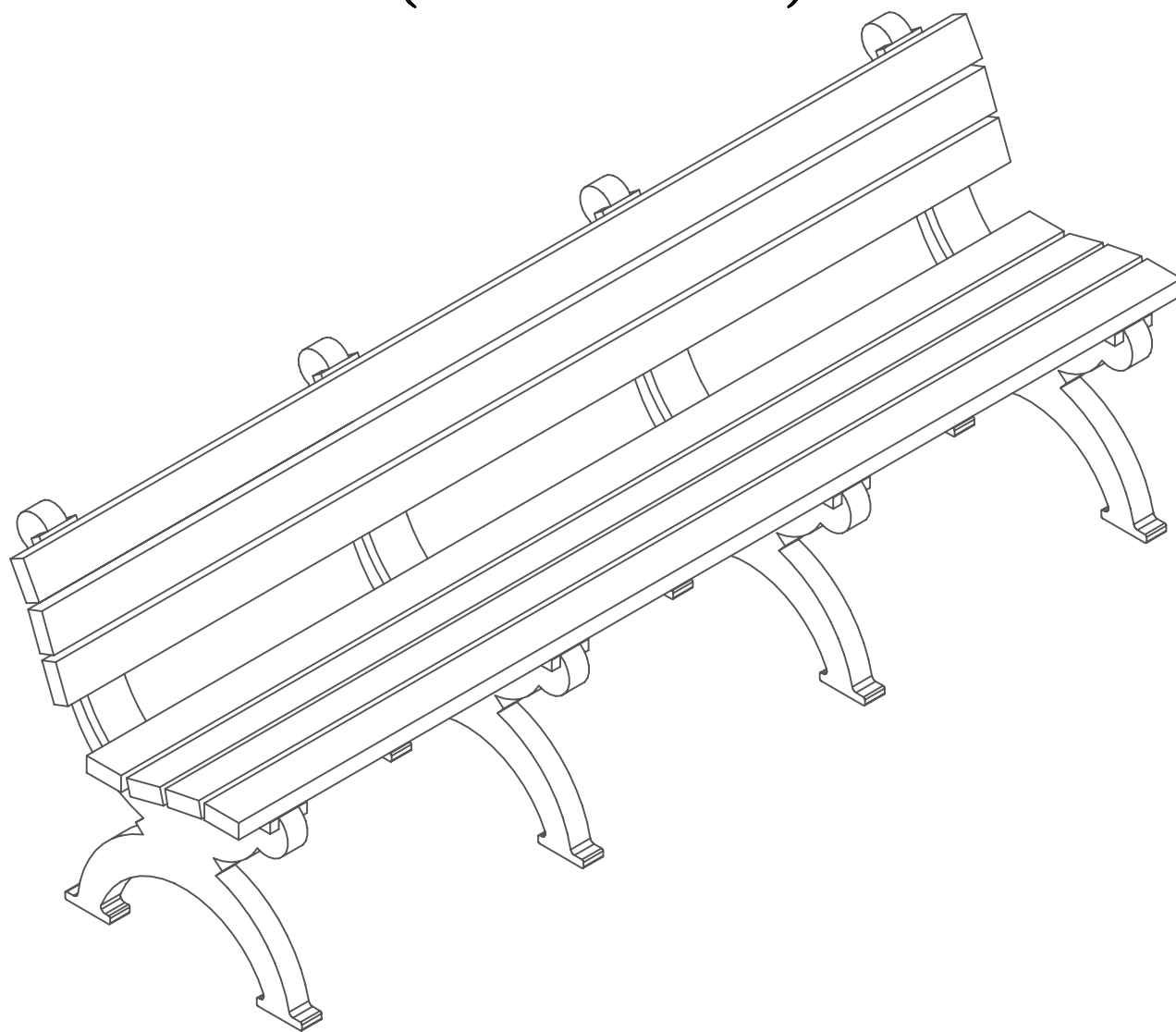

Congratulations ! !  
You have just purchased the finest recycled plastic  
park bench available. Enjoy ! ! !

Before assembly, please make sure all components are included.



( 1 ) - One Fastener Pack  
FP-MB8B-CU-01

FP - Fastener Pack

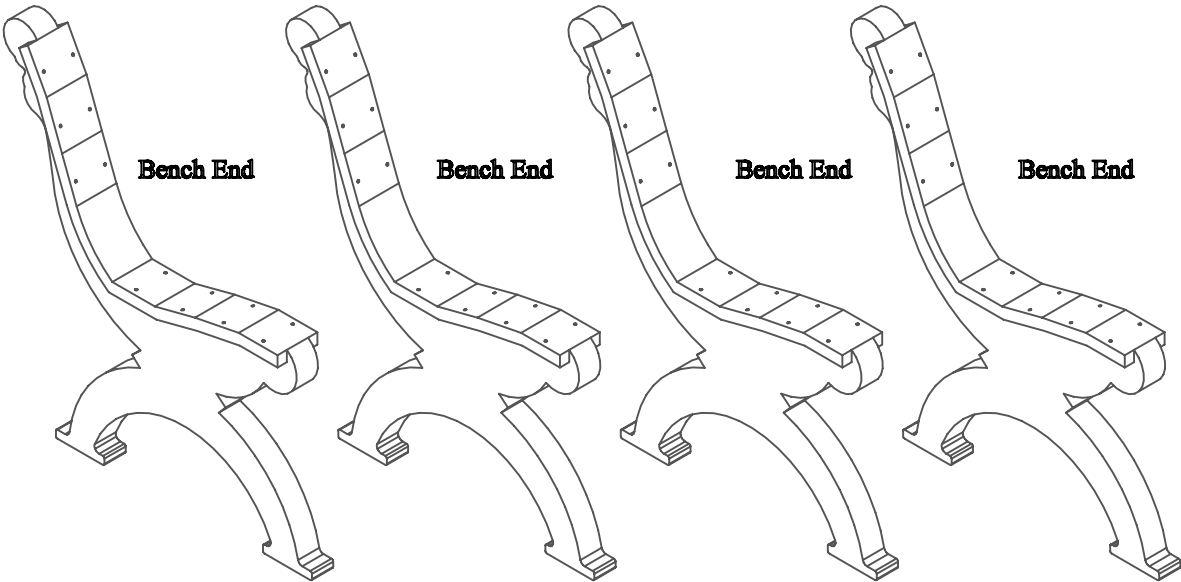

( 4 ) - Four Bench Ends  
PS-MBBE-A-01

. .	. .	. .	. .
. .	. .	. .	. .
. .	. .	. .	. .
. .	. .	. .	. .
. .	. .	. .	. .
. .	. .	. .	. .
. .	. .	. .	. .

( 7 ) - Seven Bench Boards  
BP-MB8B-A-01

Before assembly, please make sure all fasteners are included.

56 - #12 x 2" Pan Head Phillips Screw



Also needed for this assembly will be the following materials:

1 - #3 Phillips Drive Bit

### Fig #1:

In order to make the assembly of this Monarque Bench easier while going through the assembly process the board positions are numbered and will be referenced in later steps.

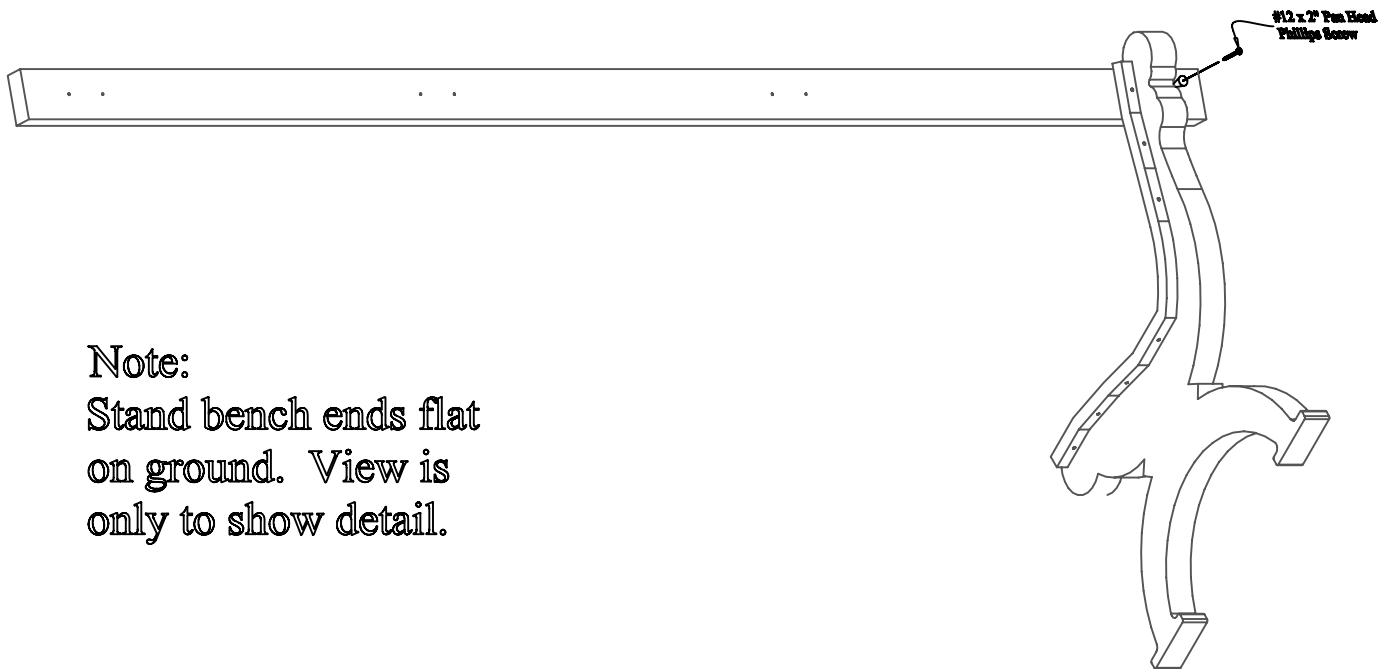
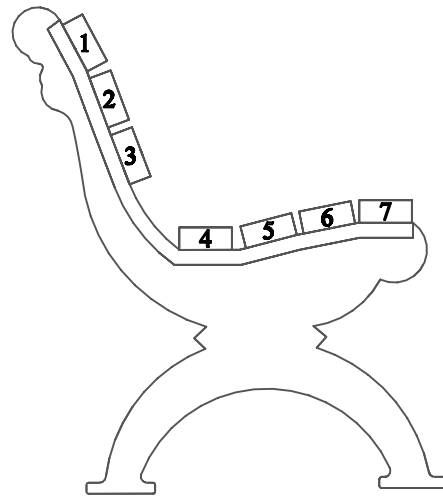

### Note:

Stand bench ends flat on ground. View is only to show detail.

### Step #1:

Stand (1) One bench end upright and place (1) One bench board on position 1 being sure to align the pilot holes to the pre-drilled holes in the bench end. After the holes are properly aligned, fasten with (1) One #12 x 2" Pan Head Phillips Screw in the pre-drilled hole on the right side of the bench end.

Note: Do not tighten screw completely. This will be done in a later step.

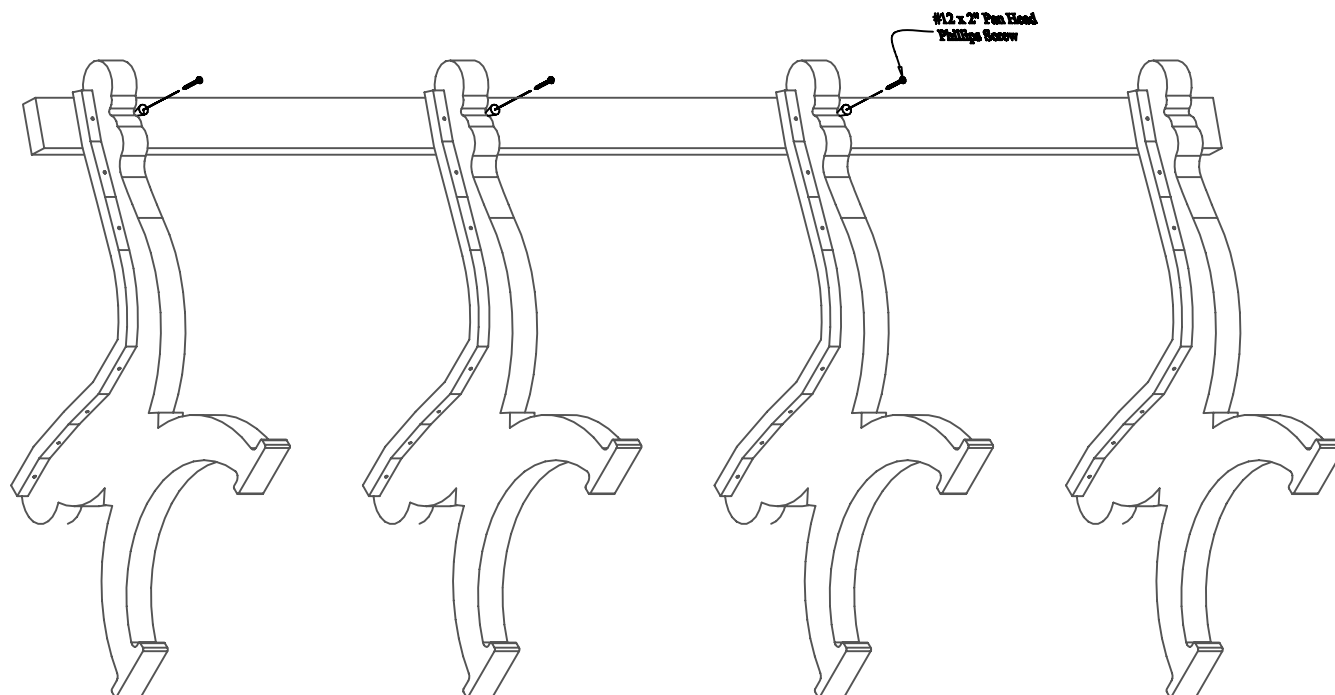

### Step #2:

Stand the other (3) Three bench ends upright, one at a time, and place the bench board already attached to the first bench end, on position 1 being sure to align the pilot holes with the pre-drilled holes in the bench end. After the holes are properly aligned, fasten with (1) One #12 x 2" Pan Head Phillips Screw in the pre-drilled hole on the right side of the bench end.

Note: Do not tighten screws completely. This will be done in a later step.

### Step #3:

Align the pilot holes on the bench board to the pre-drilled holes on the left side of the bench ends. After the holes are properly aligned, fasten with (1) One #12 x 2" Pan Head Phillips Screw per bench end.

Note: Be sure to tighten screws completely after this step.

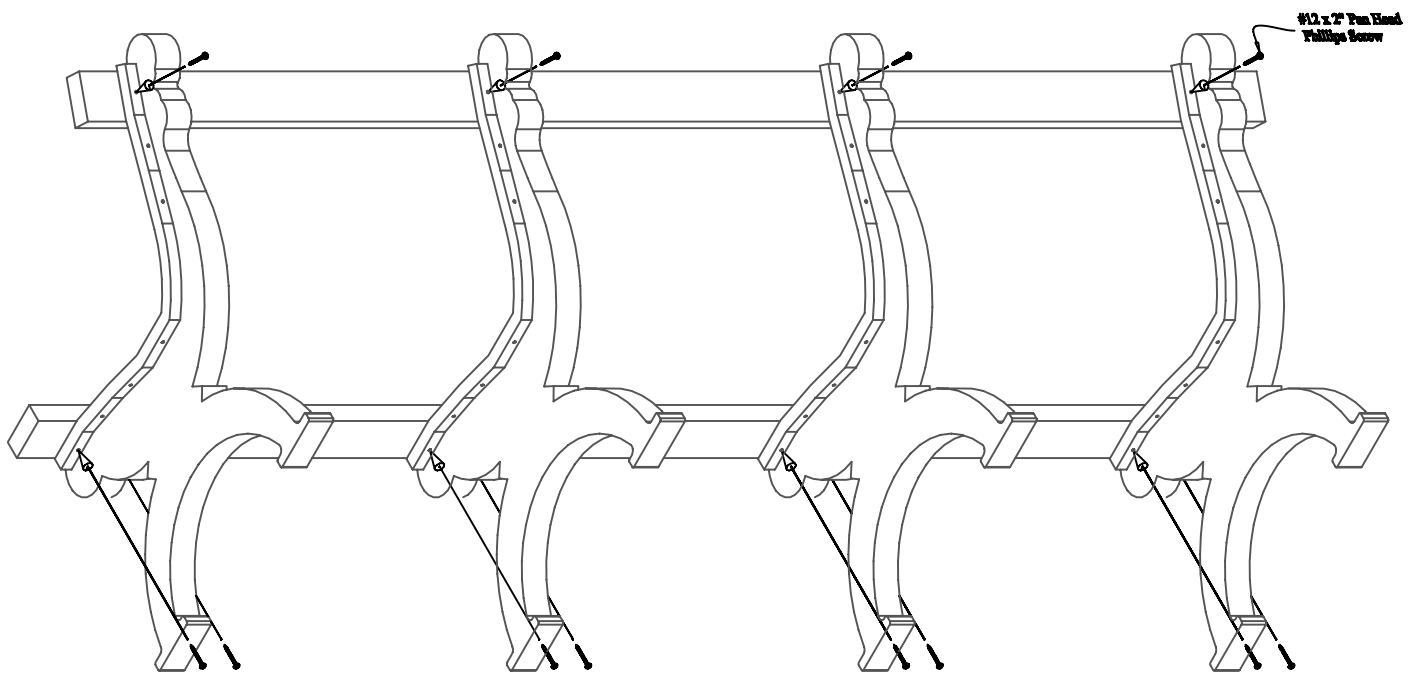

### Step #4:

Place a second bench board on position 7. Repeat Steps 1 - 3 to attach. Use (1) One #12 x 2" Pan Head Phillips Screw per hole to fasten.

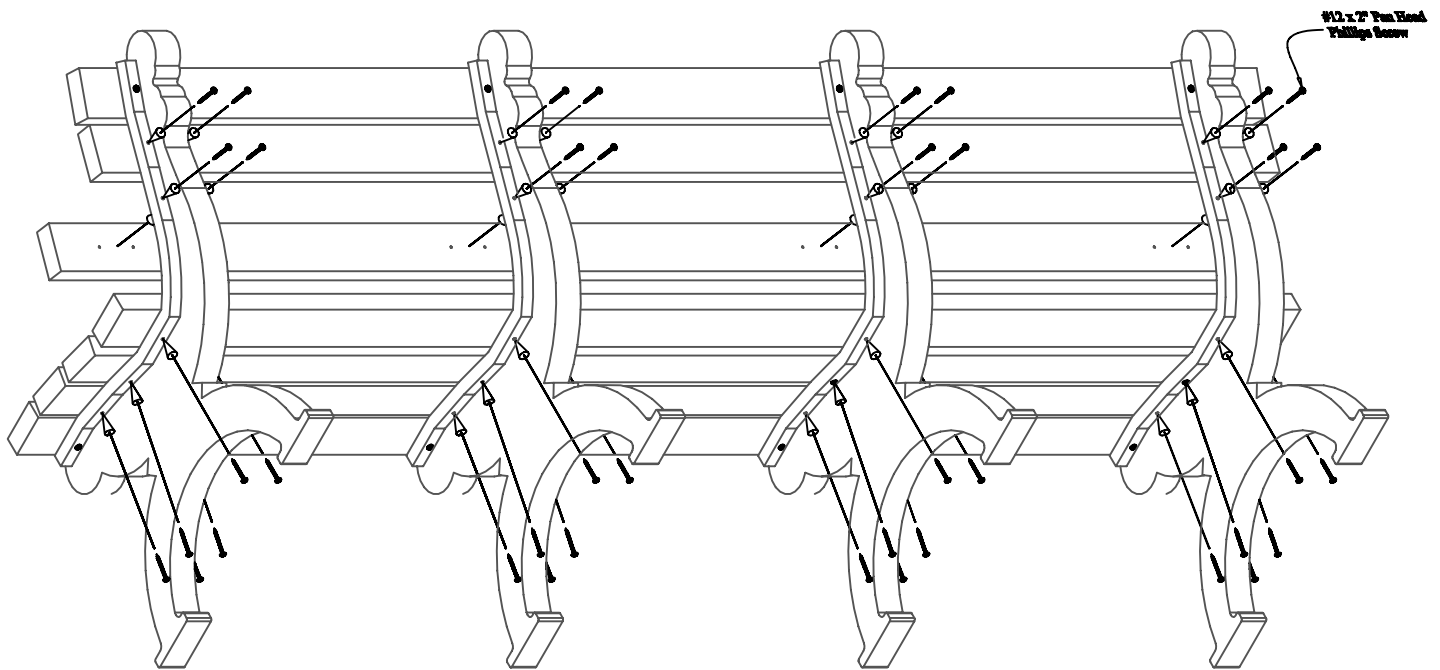

### Step #5:

Repeat Steps 1 - 3 to attach bench boards with arm holes (B) on positions 2, 3, 4 5 & 6. Use (1) One #12 x 2" Pan Head Phillips Screw per hole to fasten.

DEAR VALUED CUSTOMER,

THANK YOU FOR PURCHASING THIS  
PRODUCT. THIS PRODUCT IS  
MANUFACTURED USING RECYCLED  
MATERIALS AND MAY HAVE SLIGHT  
COLOR VARIATIONS, OCCASIONAL  
SPECKS OF COLOR OR IRREGULAR  
SURFACE PATTERNS. THESE ARE  
NORMAL CONDITIONS OF RECYCLED  
PLASTICS AND MAKE EACH PIECE OF  
FURNITURE UNIQUE. THESE  
CHARACTERISTICS DO NOT AFFECT  
THE STRENGTH, QUALITY OR  
PERFORMANCE OF THE PRODUCT.

THANK YOU AGAIN FOR PURCHASING  
THIS PRODUCT AND HELPING OUR  
ENVIRONMENT.